

4X4SDV8

STEAM, DETERGENT & VACUUM 8 BAR

Quick Start Guide

Get setup and ready to clean

WHAT'S INCLUDED

 SDV8	 Mains Power Cable 11RM00061 (UK) 11RM00062 (EU)	 User Manual	 Quick Start Guide	 4 Metre Hose 15RM00031	 2 x Extension Tubes 15RM00003
 Upholstery Tool 15RM00013	 Window Squeegee 15RM00008	 Floor Brush 15RM00027	 Brush Insert 15RM00028	 Squeegee Insert 15RM00029	 Carpet Insert 15RM00030
 150mm Nozzle 15RM00040	 150mm Brush 15RM00041	 150mm Squeegee 15RM00042	 Crevice Tool 15RM00043	 Long Steam Lance 15RM00050	 Short Steam Lance 15RM00051
 *10 x Nylon Brushes 15RM00019	 *10 x Brass Brushes 15RM00020	 Service Kit SUBA15	 Glasses	 Gloves	

* only 5 brushes supplied with machine as standard

WHAT YOU NEED

- Wear safety shoes gloves, goggles and any other PPE as specified by local regulations
-  Please read and comply with the safety instructions found in the user manual prior to using the machine. Retain this document for future reference. These instructions are also available on our website:
www.matrixcleaningsystems.co.uk
- Areas to clean

Lets get started

GET TO KNOW YOUR MACHINE

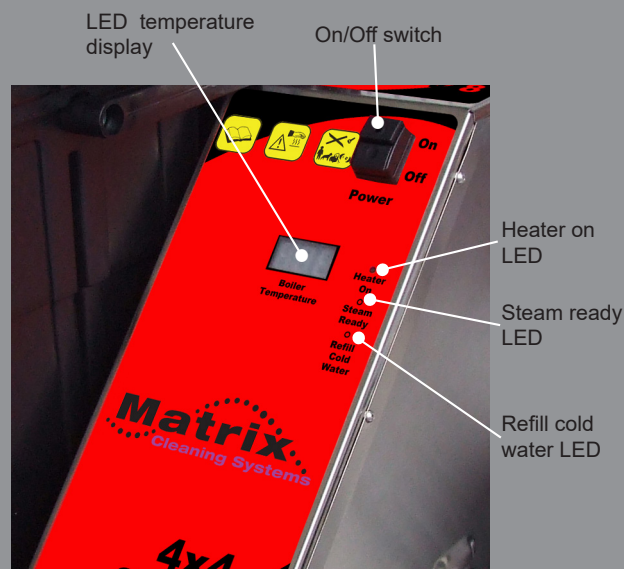
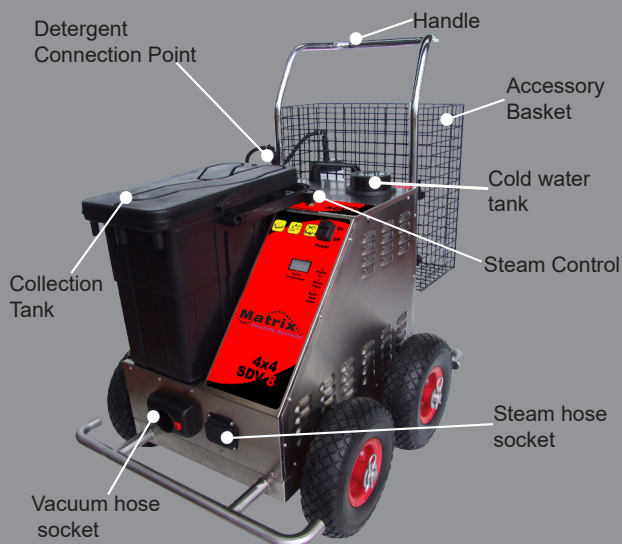

PREPARE YOUR MACHINE



1. Connect handle to the back of the machine using the 4 wing nuts provided.



2. Leave the top wing nuts loose for the basket to be mounted.



3. Mount the basket and tighten wing nuts fully.



4. Using clean cold water fill the reservoir and replace cap.



5. If desired. Fill the detergent bottle with suitable detergent.

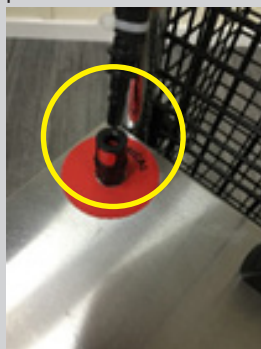

6. Connect the detergent bottle to the detergent connection point.



7. Connect vacuum hose, clicking it into position. Ensure it cannot be pulled out.



8. Lift the flap and connect the hose ensuring the pin locks into position.



9. Plug your machine into a suitable power supply.

Switching on the machine



10. Turn ON the machine with the on/off switch.



11. The heater on LED will illuminate.



12. In Approx. 10 mins the steam ready LED will illuminate. The machine is now ready to be used.

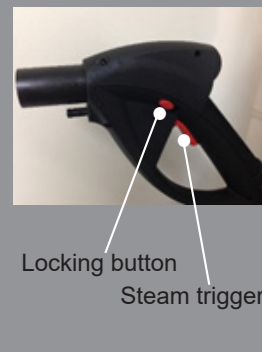

13. The red trigger will release steam when pressed. The button will lock the steam trigger in the off position.



14. The left hand switch will activate the vacuum and the right hand momentary switch is for the detergent.

During use



15. The steam output can be adjusted by turning the steam control.



16. Affix your desired accessory for your cleaning task and ensure it is locked into position.

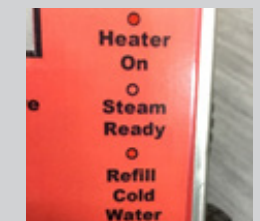

17. Refill Cold water when the refill cold water light illuminates and a intermittent beeping noise can also be heard.



18. If detergent stops working. Refill detergent bottle with suitable detergent.



19. If the vacuum stops suctioning, switch off the machine and empty the collection tank.